

# Dominis

## PRECISION PROPELLERS FOR HIGH SPEED VESSELS AND SUPER YACHTS



Design and manufacturing  
of superior precision propellers

Design and supply of propeller  
shaft-lines for super yachts

### ABOUT DOMINIS

Dominis was founded in 1985 with a vision to build high precise propellers that would reduce noise and vibration, and increase fuel efficiency.

By the late 1990's the company developed Dominis IPMS (Integrated Propeller Manufacturing System), a state-of-the-art technology and manufacturing system, which allows us to CNC mill large sculptured surfaces such as propellers and impellers to "final form and finish".

Monoblock propellers, CP propeller blades and water jet impellers manufactured by Dominis have been used on Canadian and US military and coast guard vessels.

We are constantly improving our processes, tooling and CAD/CAM programming.

At Dominis, we are proud to have completely eliminated robotic and hand grinding from the manufacturing process of propellers and water jet impellers.



### WHY CHOOSE DOMINIS?

#### CNC Milling

Our propellers and impellers are CNC milled to "final form and finish" (No robotic or hand grinding).

#### Superior Precision

Dominis propellers exceed class S ISO 484 tolerances

#### Decades of Professional Experience

We've been machining propellers for naval and coast guard vessels since the mid 1990's.

#### Advanced Technology

Dominis has spearheaded research into the impact of manufacturing tolerances on propeller performance.

#### Improved Performance

Dominis manufacturing processes are designed to reduce propeller noise and vibration.

#### Services

We work closely with ship builders to achieve their performance requirements.

### MAJOR SERVICES & PRODUCTS

- \* Propeller design
- \* Monoblock propellers
- \* CP Propeller blades
- \* Water jet impellers
- \* Shrouded impellers
- \* Complete propeller shaft-lines

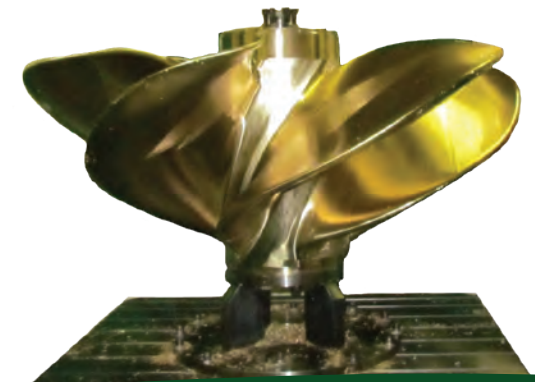

# Dominis

"DOMINIS CNC Milling to Final Form and Finish® without Robotic or Manual Grinding".

Innovative 5-axis CNC milling in Ni-Al-bronze, stainless and duplex

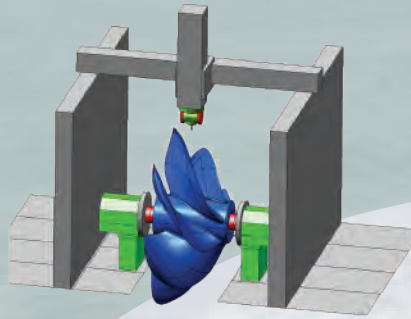

Superior precision

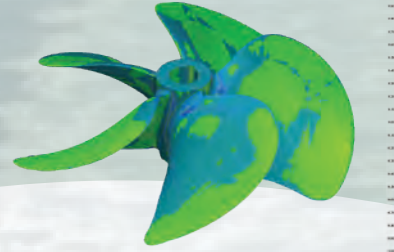

Better than class S ISO 484

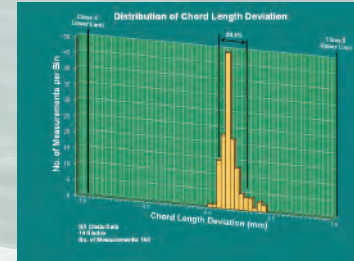

Complete propeller shaft-lines

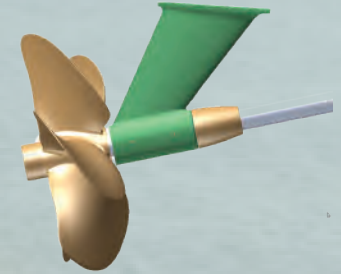

**YACHT SIZING**



Under 30 meters



30-45 meters



46-70 meters

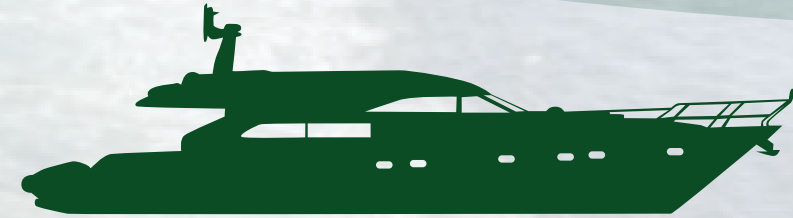

Super yachts - 70-90 meters

**FEATURED CLIENTS**

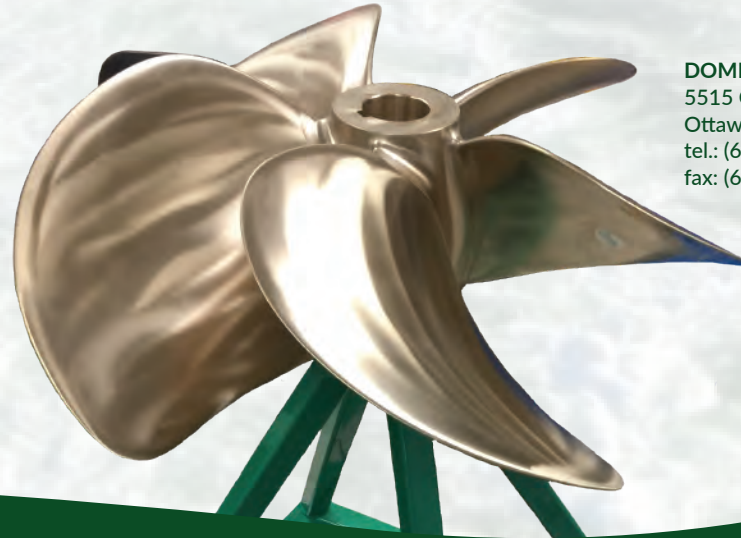

**DOMINIS ENGINEERING LTD.**  
 5515 Canotek Road, Unit 15  
 Ottawa, ON K1J 9L1 Canada  
 tel.: (613) 747-0193  
 fax: (613) 746-3321

**CONTACT:**

**Bodo Gospodnetic**  
 email: [sgospodnetic@dominis.ca](mailto:sgospodnetic@dominis.ca)  
 phone: 613-859-0182

**James F. Bonnell**  
 email: [jamesfbonnell@dominis.ca](mailto:jamesfbonnell@dominis.ca)  
 phone: 514-668-3061

**Emmett Hossack**  
 email: [emmetthossack@outlook.com](mailto:emmetthossack@outlook.com)  
 phone: 613-386-3307



**Dominis**  
[dominis.ca](http://dominis.ca)

**"We make perfect propellers for the world's fastest ships"**

-Bodo Gospodnetic, P. Eng. (Founder)